

DS OG DIN RØRHOLDER – "PRESSET MODEL"

C724030081

Rørholder uden skaft Ø8,0 mm



- Finish: Poleret

PRODUKTBESKRIVELSE

Til montage af:

- Rør

Rørholder

- Finish: Poleret

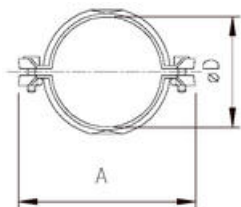

DIM. / ØD	A	Vægt	AISI 304
mm	mm	Kg.	Vare nr.
8,0-9,0	60		C724030081
10,0-11,0	60		C724030101
12,0-13,5	62		C724030121
15,0-15,9	65		C724030151
17,0-18,0	68		C724030171
19,0-19,1	68		C724030191
21,3-23,0	72	0,120	C724030211
25,0-25,4	78	0,125	C724030251
26,9-29,0	80	0,130	C724030261
30,0	80	0,140	C724030301
32,0	85	0,150	C724030321
33,7-34,0	87	0,160	C724030331

35,0	88	0,160	C724030351
38,0-38,1	91	0,170	C724030381
40,0-41,0	93	0,180	C724030401
42,0-42,9	96	0,180	C724030421
48,3	101	0,190	C724030481
50,8-51,0	104	0,200	C724030511
52,0-53,0	107	0,200	C724030521
54,0	107	0,200	C724030541
60,3	113	0,210	C724030601
63,5	116	0,210	C724030631
70,0	123	0,230	C724030701
76,0-76,2	129	0,240	C724030761
84,0-85,0	137	0,250	C724030851
88,9-90,0	143	0,270	C724030881
101,6	155	0,300	C724031011
104,0	157		C724031041
108,0	161		C724031081
114,0-114,3	167		C724031141
129,0	182		C724031291
139,7-140,0	193		C724031401
154,0	207		C724031541
168,3	221		C724031681
204,0	257		C724032041
254,0	307		C724032541
306,0	359		C724033061
355,6-356,0	409		C724033551

Rørholder med kort skaft

- Finish: Poleret

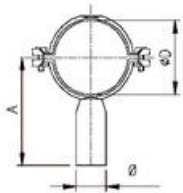

DIM. / ØD	A	Ø	Vægt	AISI 304
mm	mm	mm	Kg.	Vare nr.
8,0-9,0	54	8	0,080	C725030081
10,2-11,0	55	8	0,090	C725030101
12,0-13,5	56	8	0,090	C725030121
15,0-15,9	57	8	0,100	C725030151
17,0-18,0	58	8	0,100	C725030171
19,0-19,1	59	8	0,110	C725030191
21,3-23,0	90	21,3	0,190	C725030211
25,0-25,4	90	21,3	0,200	C725030251
26,9-29,0	90	21,3	0,200	C725030261
30,0	90	21,3	0,200	C725030301
32,0	90	21,3	0,210	C725030321
33,7-34,0	90	21,3	0,220	C725030331
35,0	90	21,3	0,220	C725030351
38,0-38,1	90	21,3	0,220	C725030381
40,0-41,0	90	21,3	0,230	C725030401
42,4-42,9	90	21,3	0,240	C725030421
48,3	90	21,3	0,240	C725030481
50,8-51,0	90	21,3	0,245	C725030511
52,0-53,0	90	21,3	0,250	C725030521
54,0	90	21,3	0,250	C725030541
60,3	90	21,3	0,260	C725030601
63,5	90	21,3	0,260	C725030631
70,0	90	21,3	0,270	C725030701
76,0-76,2	90	21,3	0,275	C725030761

84,0-85,0	90	21,3	0,300	C725030851
88,9-90,0	90	21,3	0,310	C725030881
101,6	90	21,3	0,320	C725031011
104,0	90	21,3	0,340	C725031041
108,0	92	21,3	0,360	C725031081
114,0-114,3	95	21,3	0,370	C725031141
129,0	115	21,3	0,390	C725031291
139,7-140,0	120	21,3	0,400	C725031401
154,0	127	21,3	0,450	C725031541
168,3	135	21,3	0,450	C725031681
204,0	152	21,3	0,530	C725032041
219,1			0,570	C725032191
254,0	177	21,3	0,660	C725032541
306,0	203	21,3		C725033061
355,6-356,0	183	21,3		C725033551

Rørholder med lang skaft

- Finish: Poleret

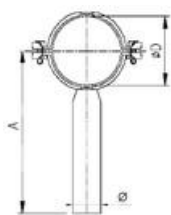

DIM. / ØD	A	Ø	Vægt	AISI 304
mm	mm	mm	Kg.	Vare nr.
8,0-9,0	154	8	0,120	C725040081
10,0-11,0	155	8	0,140	C725040101
12,0-13,5	156	8	0,150	C725040121
15,0-15,9	157	8	0,160	C725040151
17,0-18,0	158	8	0,170	C725040171

19,0-19,1	159	8	0,170	C725040191
21,3-23,0	150	21,3	0,220	C725040211
25,0-25,4	150	21,3	0,235	C725040251
26,9-29,0	150	21,3	0,250	C725040261
30,0	150	21,3	0,260	C725040301
32,0	150	21,3	0,260	C725040321
33,7-34,0	150	21,3	0,270	C725040331
35,0	150	21,3	0,270	C725040351
38,0-38,1	150	21,3	0,280	C725040381
40,0-41,0	150	21,3	0,280	C725040401
42,0-42,9	150	21,3	0,280	C725040421
48,3	150	21,3	0,290	C725040481
50,8-51,0	150	21,3	0,290	C725040511
52,0-53,0	150	21,3	0,290	C725040521
54,0	150	21,3	0,300	C725040541
60,3	150	21,3	0,300	C725040601
63,5	150	21,3	0,300	C725040631
70,0	150	21,3	0,320	C725040701
76,0-76,2	150	21,3	0,330	C725040761
84,0-85,0	150	21,3	0,360	C725040851
88,9-90,0	150	21,3	0,370	C725040881
101,6	150	21,3	0,380	C725041011
104,0	150	21,3	0,400	C725041041
108,0	150	21,3		C725041081
114,0-114,3	150	21,3		C725041141
129,0	150	21,3		C725041291