

IN-LINE MINIATURE, SPRING LOADED

BE Serien Trykreducerende regulator

BE
BE serien

- Max indgangstryk: 414 bar
- Max udgangstryk: 41.4 bar
- CV: 0.02
- Leak: Bubble-tight
- Design Proof Tryk: 150% af maximum



PRODUKTBESKRIVELSE

Tescom BE Serien

Regulator fungerer som stand alone, som en pilot ventil. Udover det kan den bruge til at konvertere de fleste Tescom low tryk regulator til en two-stage tryk reducer.

Applikationer

- Rough cut regulator
- Can be combined with a one-stage regulator to create a two-stage regulator
- Tee-ed in for a pilot source
- Non-venting

Fordele

Materiale: Nickel-plated aluminum, messing og AISI 316 rustfri stål

Positive shut-off for leak integrity

Omvendt "decaying inlet" karakteristik for at skåne følsomt udstyr

Pre sat fra fabrikken til standard "operating conditions"

Lavt flow applikationer: Cv = 0.02, 414 bar indgangstryk, 0-31 bar udgangstryk

Flere forskellige porting muligheder for gauges og relief ventiler

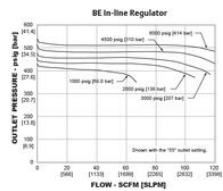

Example for selecting a part number:

BE	6	25	VC	H	4	C	4
BASIC SERIES							
BODY AND BONNET MATERIAL	1000 (A304)	2000 (202)	4000 (A14)				
NOMINAL OUTLET SETTING P₁ (PSI) bar	1000 (6.9)	2000 (13.8)	4000 (27.6)				
O-RING MATERIAL	BT - Nitrile Buna N	VT - Viton (FKM)	ET - E.P.	PTFE			
SEAT MATERIAL	BT - Nitrile Buna N	VT - Viton (FKM)	ET - E.P.	PTFE			
OPERATING TEMPERATURE	-80 to 160°F -40 to 74°C	-10 to 140°F -23 to 60°C	-80 to 160°F -40 to 74°C	-80 to 160°F -40 to 74°C			
PORTING CONFIGURATION (Date Model)	A - no gauge ports	B - two gauge ports	F - one gauge port				
INLET, OUTLET AND GAUGE PORTS	Z - 1/2" Female NPT	K - 1/2" Female NPT	G - 1/2" Male NPT	C - 1/2" Male NPT	E - 1/2" Female SAE	M - 1/2" Male SAE	N - 1/2" Male SAE
							S - None

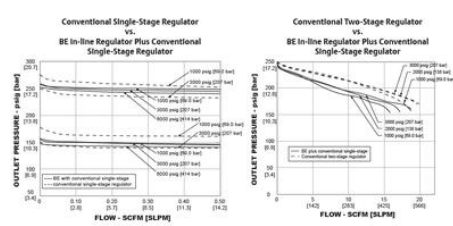
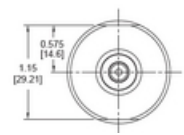
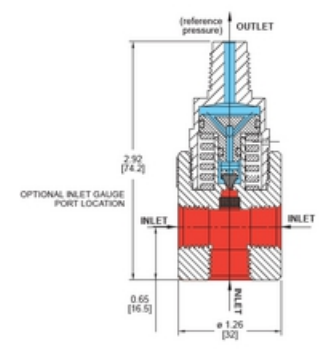

Example for selecting a part number:

BE	6	25	VC	H	4	C	4
BASIC SERIES							
BODY AND BONNET MATERIAL	1000 (A304)	2000 (202)	4000 (A14)				
NOMINAL OUTLET SETTING P₁ (PSI) bar	1000 (6.9)	2000 (13.8)	4000 (27.6)				
O-RING MATERIAL	BT - Nitrile Buna N	VT - Viton (FKM)	ET - E.P.	PTFE			
SEAT MATERIAL	BT - Nitrile Buna N	VT - Viton (FKM)	ET - E.P.	PTFE			
OPERATING TEMPERATURE	-80 to 160°F -40 to 74°C	-10 to 140°F -23 to 60°C	-80 to 160°F -40 to 74°C	-80 to 160°F -40 to 74°C			
PORTING CONFIGURATION (Date Model)	A - no gauge ports	B - two gauge ports	F - one gauge port				
INLET, OUTLET AND GAUGE PORTS	Z - 1/2" Female NPT	K - 1/2" Female NPT	G - 1/2" Male NPT	C - 1/2" Male NPT	E - 1/2" Female SAE	M - 1/2" Male SAE	N - 1/2" Male SAE
							S - None

