



TERMOMETER STANDARDUDFØRSEL

Serie A50

A50-12012891

Ø63 SS 0-120°C 40x9mm G1/2B" TW

- Måleområde fra -30 til 200°C
- Diameter 63, 80, 100 og 160mm
- Inklusiv dyklomme af kobberlegering
- Nøjagtighedsklasse 2 iht. EN 13190
- Nuljustering i bunden af indstikket



PRODUKTBESKRIVELSE

SPECIFIKATIONER

Diameter	63 mm
Indstikslængde	40 mm
Materiale hus	Rustfrit stål
Materiale medieberørte del	Kobberlegering
Plug diameter	9 mm
Temperaturområde fra	0 °C
Temperaturområde til	120 °C
Tilslutning	G1/2
Tilslutningsposition	Bagud

Dimensions in mm

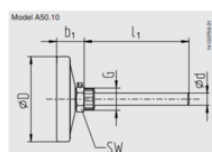

In addition, see the 3D data on the product details page at www.wika.com

NS	Dimensions in mm				L1	SW	Weight in kg
	b1	Ø d	Ø D	G			
63	24	11.5"	63	G 1/2 B	40, 60, 100, 160, 200, 250, 300	21	0.08
80	27	11.5"	80	G 1/2 B	40, 60, 100, 160, 200, 250, 300	21	0.10
100	30	11.5"	100	G 1/2 B	40, 60, 100, 160, 200, 250, 300	21	0.13
160	32	11.5"	160	G 1/2 B	40, 60, 100, 160, 200, 250, 300	21	0.28

1) Ø d = 11 for L = 100 Remained length

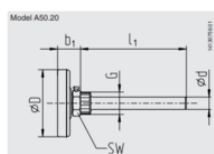

In addition, see the 3D data on the product details page at www.wika.com

NS	Dimensions in mm				L1	SW	Weight in kg
	b1	Ø d	Ø D	G			
63	20	11.5"	63	G 1/2 B	40, 60, 100, 160, 200, 250, 300	21	0.09
80	22	11.5"	80	G 1/2 B	40, 60, 100, 160, 200, 250, 300	21	0.12
160	24	11.5"	160	G 1/2 B	40, 60, 100, 160, 200, 250, 300	21	0.17

1) Ø d = 11 for L = 100 Remained length

Dimensions in mm

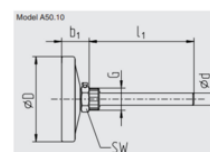

In addition, see the 3D data on the product details page at www.wika.com

NS	Dimensions in mm				L1	SW	Weight in kg
	b1	Ø d	Ø D	G			
63	24	11.5"	63	G 1/2 B	40, 60, 100, 160, 200, 250, 300	21	0.08
80	27	11.5"	80	G 1/2 B	40, 60, 100, 160, 200, 250, 300	21	0.10
100	30	11.5"	100	G 1/2 B	40, 60, 100, 160, 200, 250, 300	21	0.13
160	32	11.5"	160	G 1/2 B	40, 60, 100, 160, 200, 250, 300	21	0.28

1) Ø d = 11 for L = 100 Remained length

Model A50.20

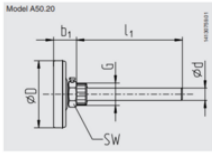

In addition, see the 3D data on the product details page at www.wika.com

HS	Dimensions in mm						Weight in kg
	b1	Ø d	Ø D	G	L1	SW	
83	20	11.5 ¹⁾	63	G 1/8	40, 60, 100, 160, 200, 250, 300	21	0.09
88	22	11.5 ¹⁾	80	G 1/8	40, 60, 100, 160, 200, 250, 300	21	0.12
100	24	11.5 ¹⁾	100	G 1/8	40, 60, 100, 160, 200, 250, 300	21	0.17

¹⁾ Ø d = 11.5 for L = 100 (standard length)