

HØJ NØJAGTIGHED, VENTING, SPRING, DOME OG AIR LOADED, DIAPHRAGM SENSOR

26-1600 serien Trykreducerede Regulator

26-1600
26-1600 serien

- Max indgangstryk: 414 bar
- Max udgangstryk: 34.5 bar
- CV: 0.08
- Temperaturområde: -40 til 74°C
- Bubble-tight



PRODUKTBESKRIVELSE

Tescom 26-1600 Serien

Høj nøjagtig, diaphragm sensor trykreducerende regulator som tilbyder en justerbar venting som standard. Panel montering, integreret 40 micron filter, håndtag til at justere torque som sikre et robust og indstilt design med mange modifikationer.

Applikationer

- Test equipment
- Calibration stands
- Production equipment

Fordele

Venting som standard (tilgængelig med captured venting)
Høj nøjagtighed
Features a non-rising stem and low operating torque
Kompakt design
Filter som forlænger seat life
Flere indgangs porte
Panel montering (bracket included)
Nem at servicere
High flow model tilgængelig (Cv = 0.24maximum
indgangstryk 207 bar)

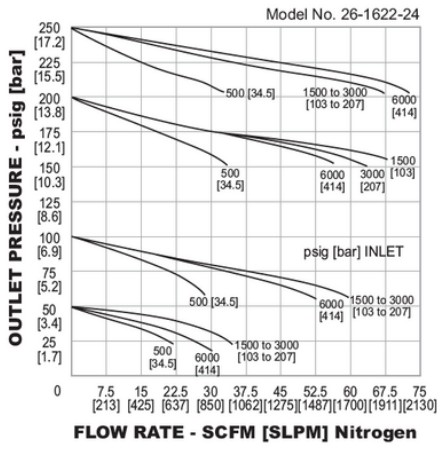

Example for selecting a part number:

26-16	6	2	2	4	
BASIC SERIES	BODY MATERIAL	MAXIMUM INLET PRESSURE	OUTLET PRESSURE RANGES	INLET AND OUTLET PORT TYPE	INLET AND OUTLET PORT SIZE
26-16	1 = Brass 2 = Aluminum (2024 T351) 6 = 316 Stainless Steel	5000 psig / 345 bar 5000 psig / 345 bar 6000 psig / 414 bar	0 - 0.50 psig 0 - 3.4 bar 1 - 0.150 psig 0 - 10.3 bar 2 - 0.250 psig 0 - 17.2 bar 3 - 0.500 psig 0 - 34.5 bar	1 = SAE 2 = NPT 3 = MS3549	4 = 1/4" 6 = 3/8" 8 = 1/2" (Stainless Steel only)

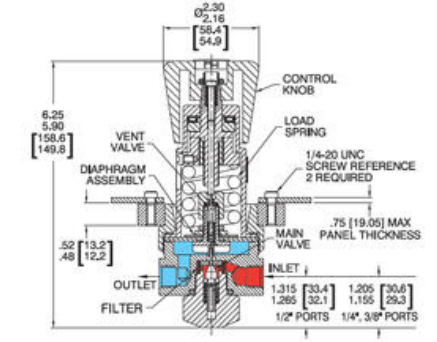

PANEL CUT-OUT

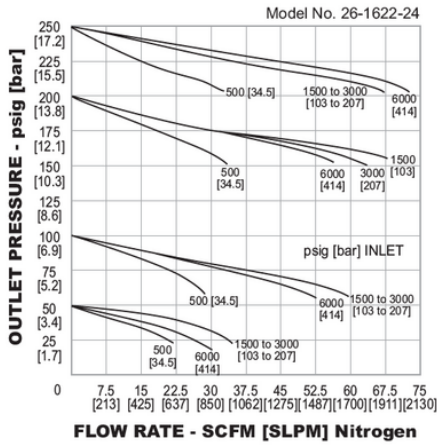
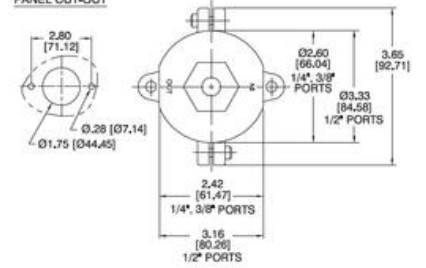

Example for selecting a part number:

26-16	6	2	2	4	
BASIC SERIES	BODY MATERIAL	MAXIMUM INLET PRESSURE	OUTLET PRESSURE RANGES	INLET AND OUTLET PORT TYPE	INLET AND OUTLET PORT SIZE
26-16	1 = Brass 2 = Aluminum (2024 T351) 6 = 316 Stainless Steel	5000 psig / 345 bar 5000 psig / 345 bar 6000 psig / 414 bar	0 - 0.50 psig 0 - 3.4 bar 1 - 0.150 psig 0 - 10.3 bar 2 - 0.250 psig 0 - 17.2 bar 3 - 0.500 psig 0 - 34.5 bar	1 = SAE 2 = NPT 3 = MS3549	4 = 1/4" 6 = 3/8" 8 = 1/2" (Stainless Steel only)

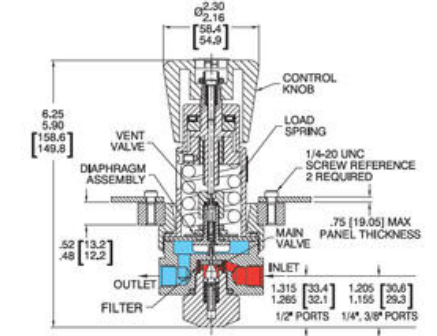

PANEL CUT-OUT

